

SIX



016799



“A monter soi-même”

« IMPORTANT - À lire soigneusement - À conserver pour consultation ultérieure. »

- « Vérifier la présence et l'état de la quincaillerie et des pièces avant de débuter le montage »
- « Ne pas monter ou utiliser le mobilier si certains éléments sont cassés, endommagés ou manquants, et n'utiliser que des pièces détachées approuvées par le fabricant. »
- « Utiliser uniquement l'outillage fourni ou préconisé. »
- « Serrer correctement les éléments de fixation avec l'outillage fourni ou préconisé. »
- « Un mauvais montage, calage ou manutention peut entraîner une fragilisation des assemblages et/ou des pièces. »
- « Tenir éloigné les jeunes enfants lors de l'assemblage. Présence de petites pièces susceptibles d'être ingérées. »
- « Utiliser votre produit sur un sol stabilisé, de niveau »
- « Il convient que tous les dispositifs d'assemblage soient toujours convenablement serrés et régulièrement vérifiés, et resserrés, si nécessaire. » ;
- « Ne pas déplacer un mobilier chargé. »

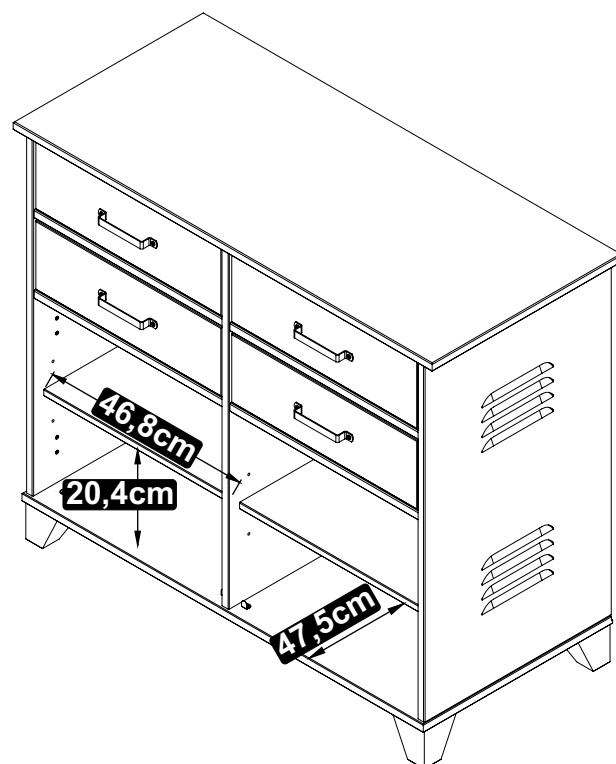
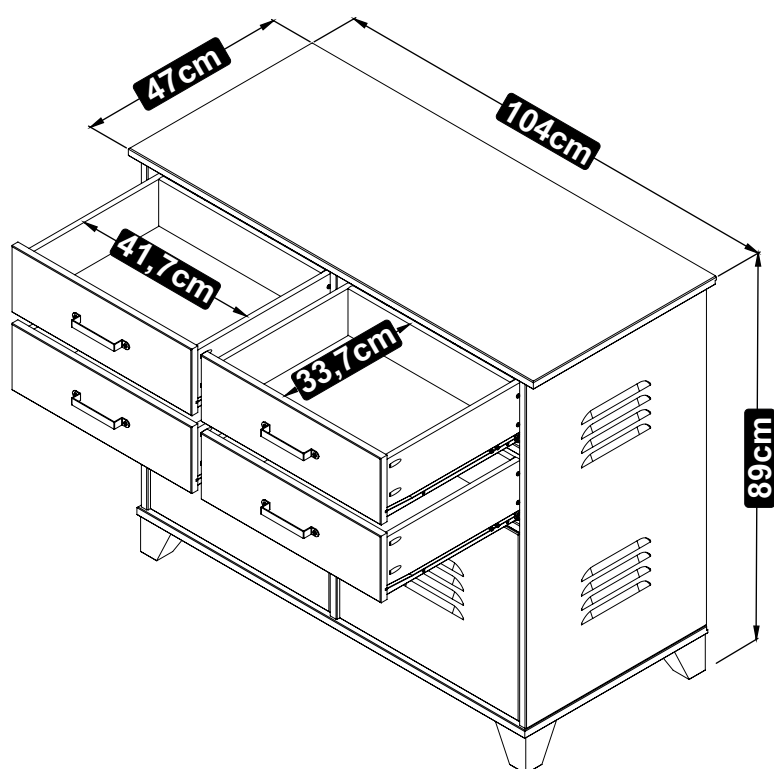

COMPOSITION DU PRODUIT:
PIN MASSIF ET MDF

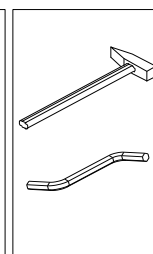
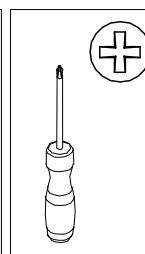
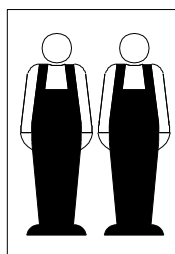
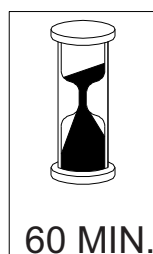

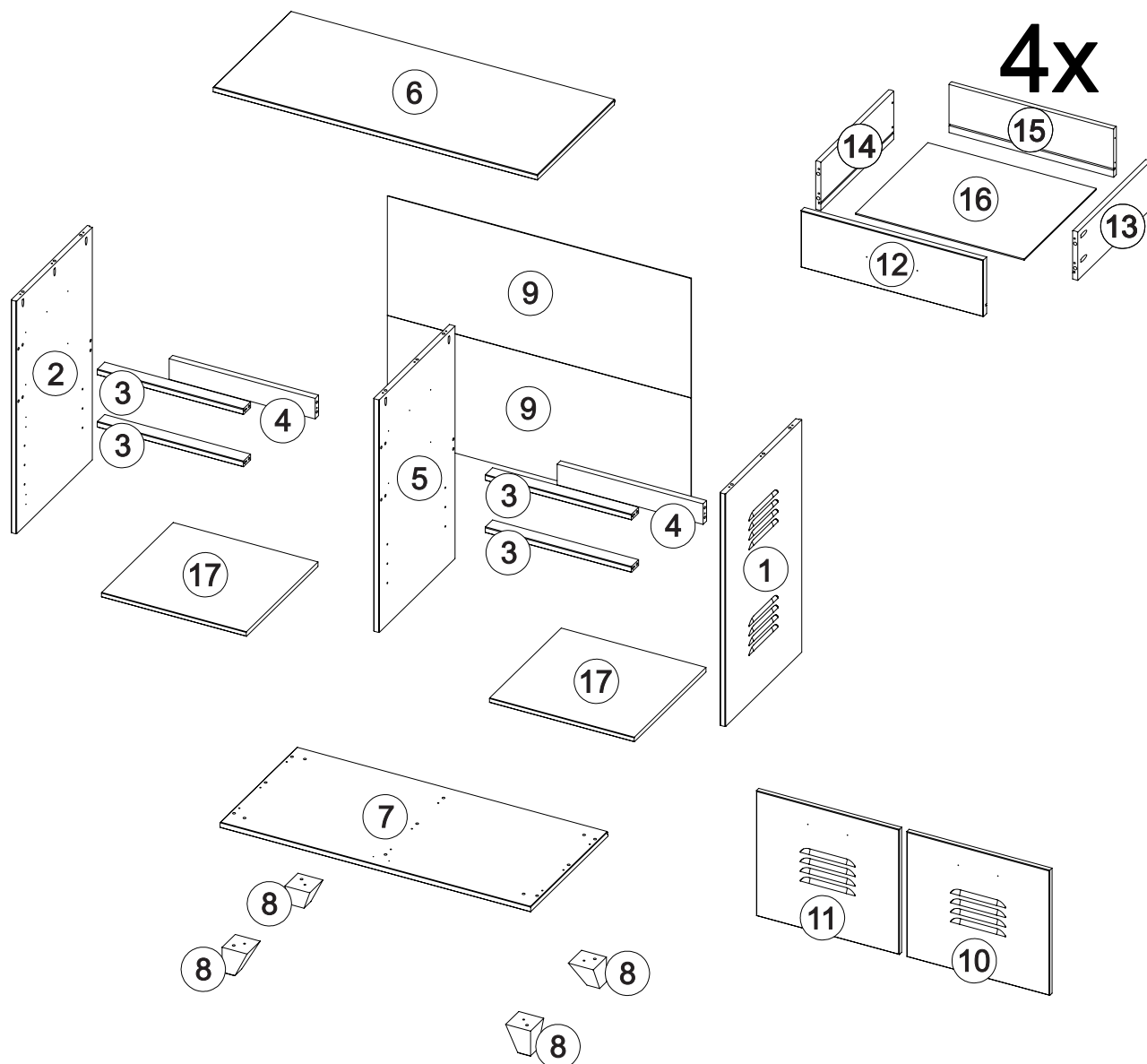

IMPORTANT - LIRE ATTENTIVEMENT - À CONSERVER POUR RÉFÉRENCE ULTÉRIEURE

“Les meubles contenant des panneaux à base de bois (panneaux de particules, panneaux de fibres, contreplaqué...) Peuvent émettre des substances polluantes dans l’air intérieur. Il est ainsi recommandé, après l’installation du meuble dans son logement, d’aérer fréquemment la pièce concernée pendant au moins quatre semaines afin de réduire son exposition aux polluants émis par le meuble.”

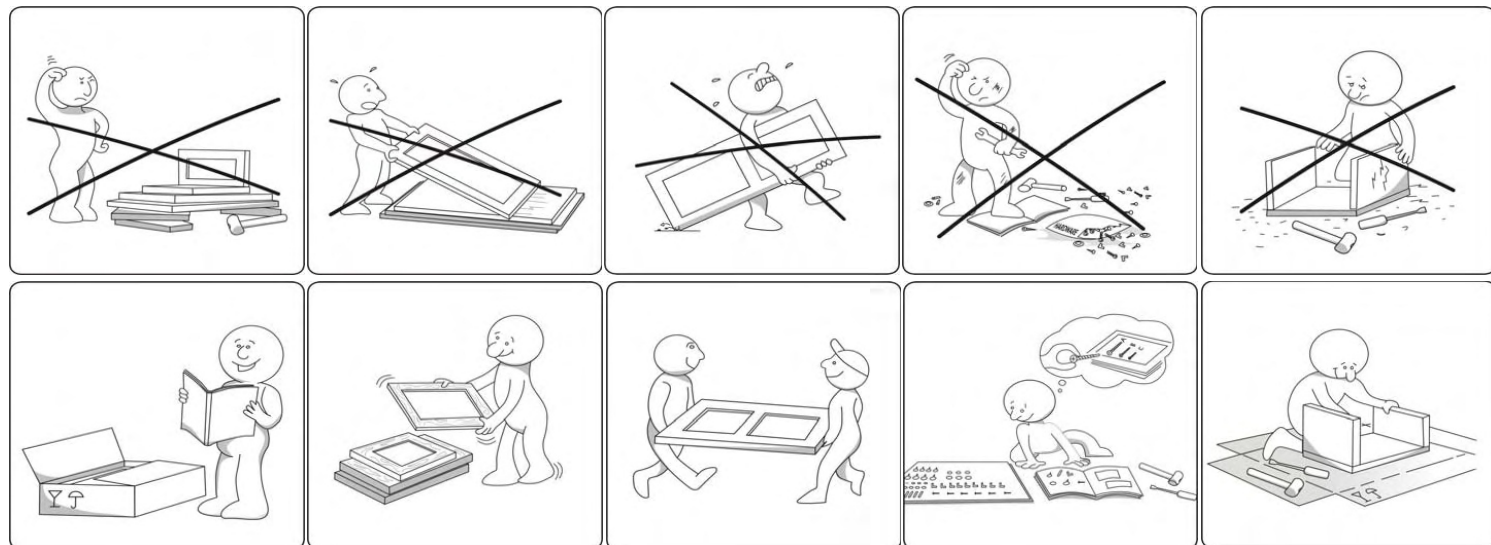

A x 64

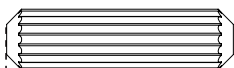

Ø8,0x30mm

B x 04

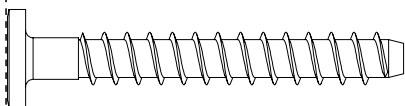

Ø7,0x50mm

C x 09



Ø3,5x40mm

D x 53

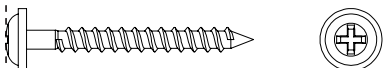

Ø3,5x30mm

E x 09

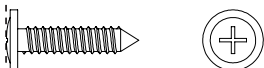

Ø3,5x16mm

F x 56

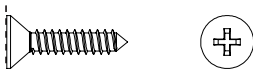

Ø3,5x16mm

G x 14



Ø3,5x12mm

H x 28

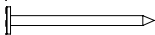

I x 08

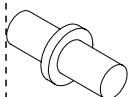

P x 04

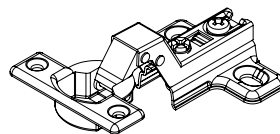

J x 02

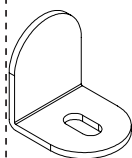

Q x 06

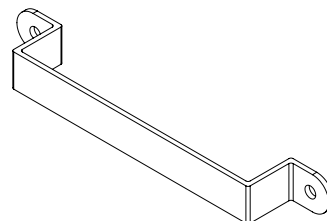

K x 05

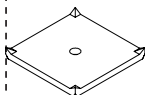

R x 01

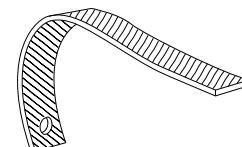

L x 04

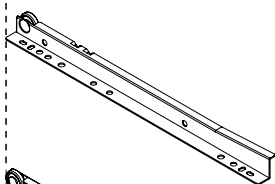

S x 02

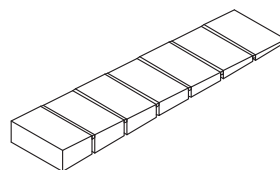

M x 04

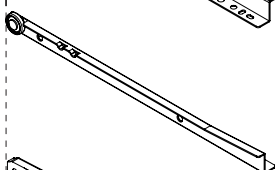

N x 04

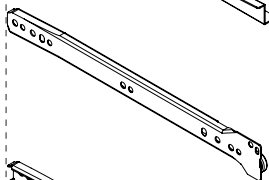

T x 02



O x 04

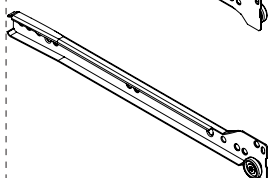

U x 01

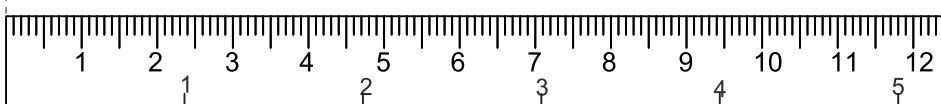

1

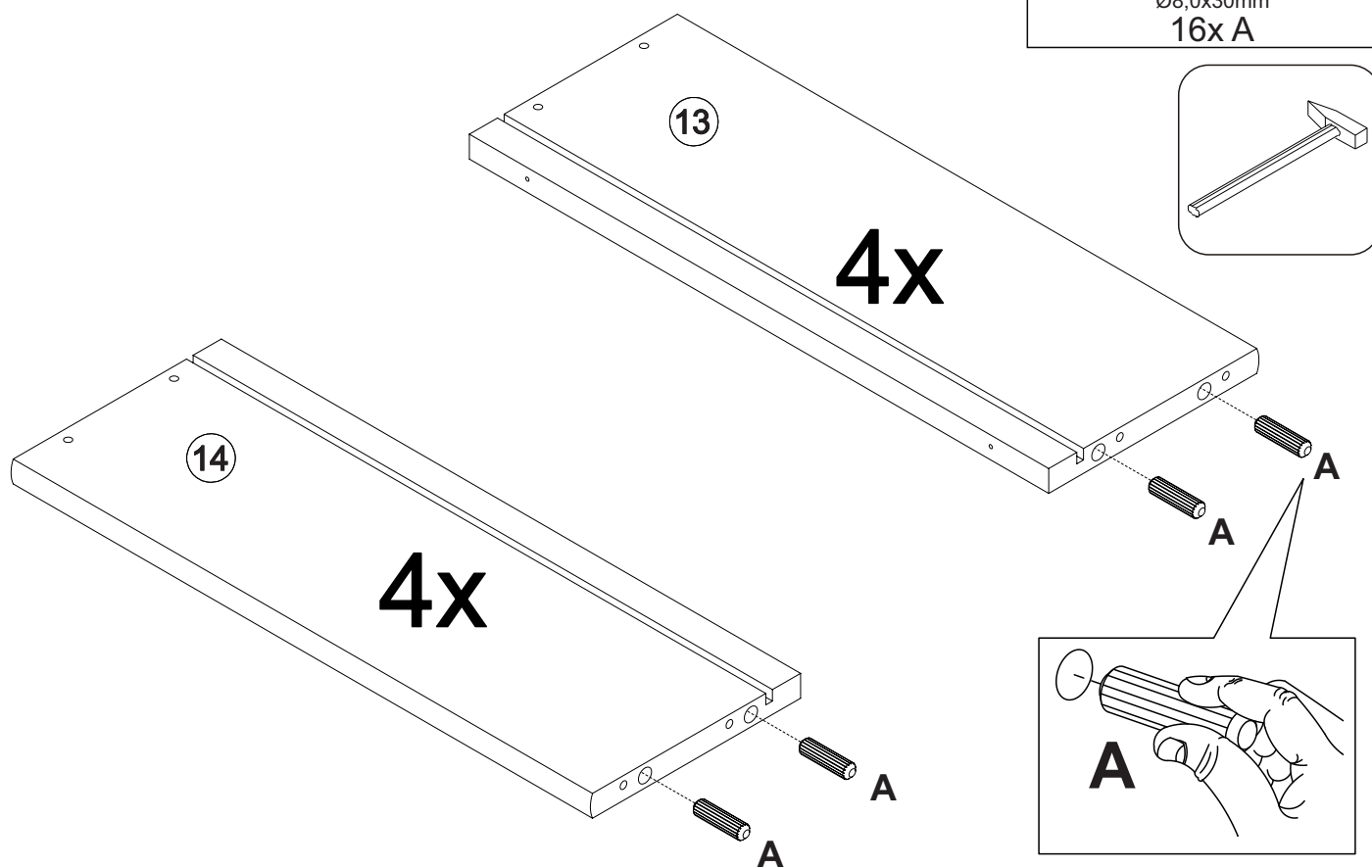

2

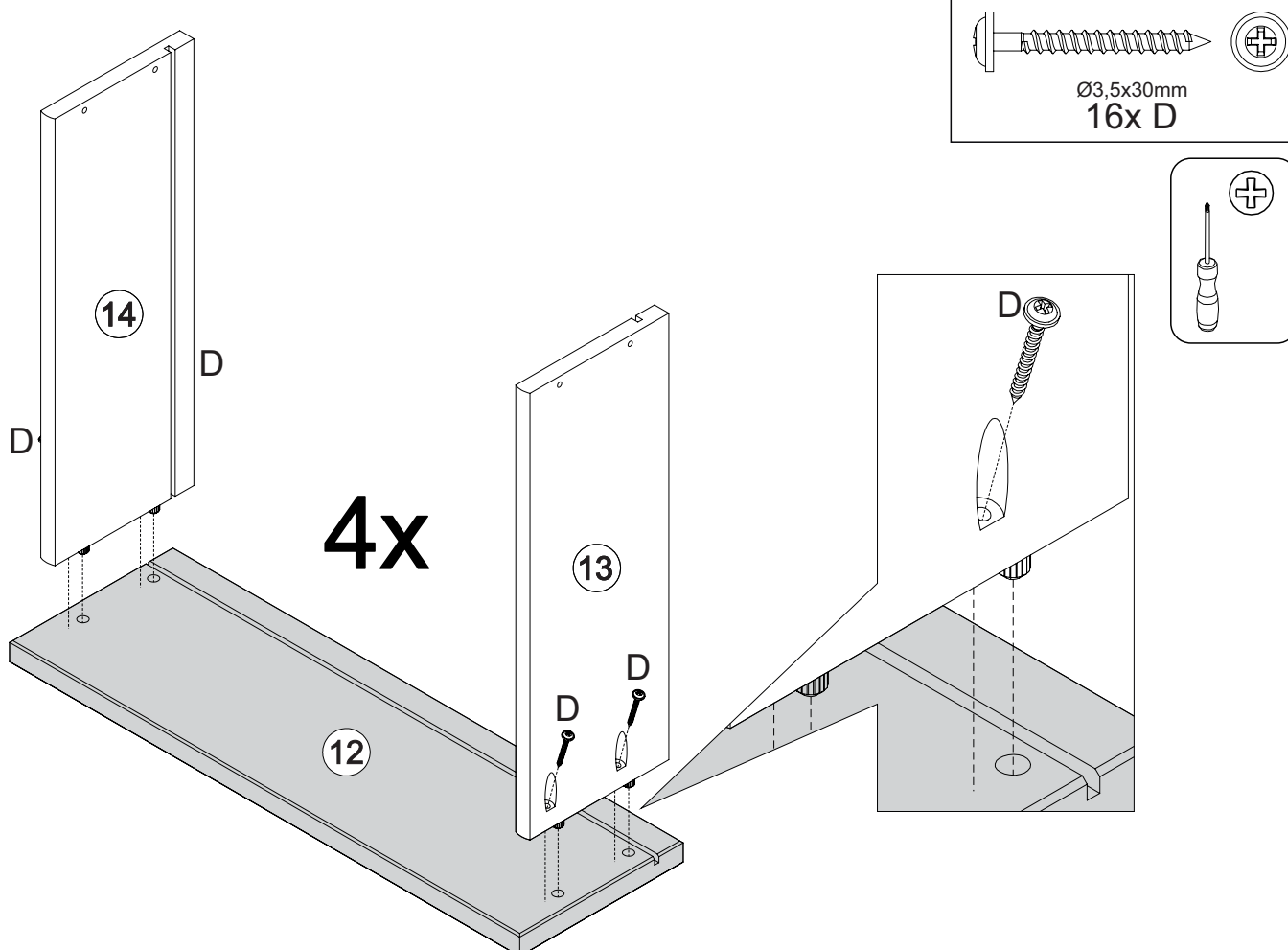

3

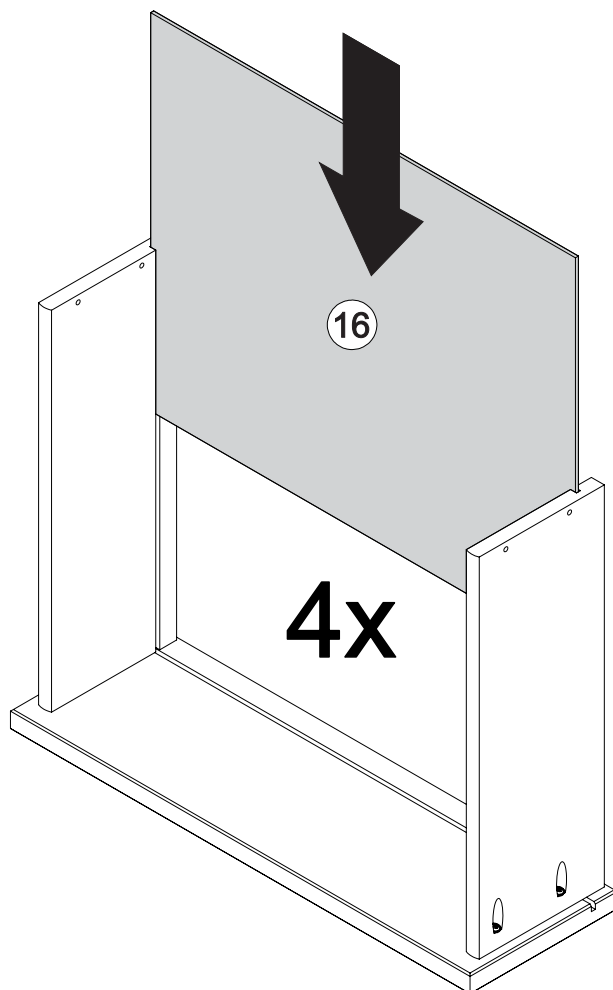

4

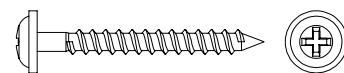
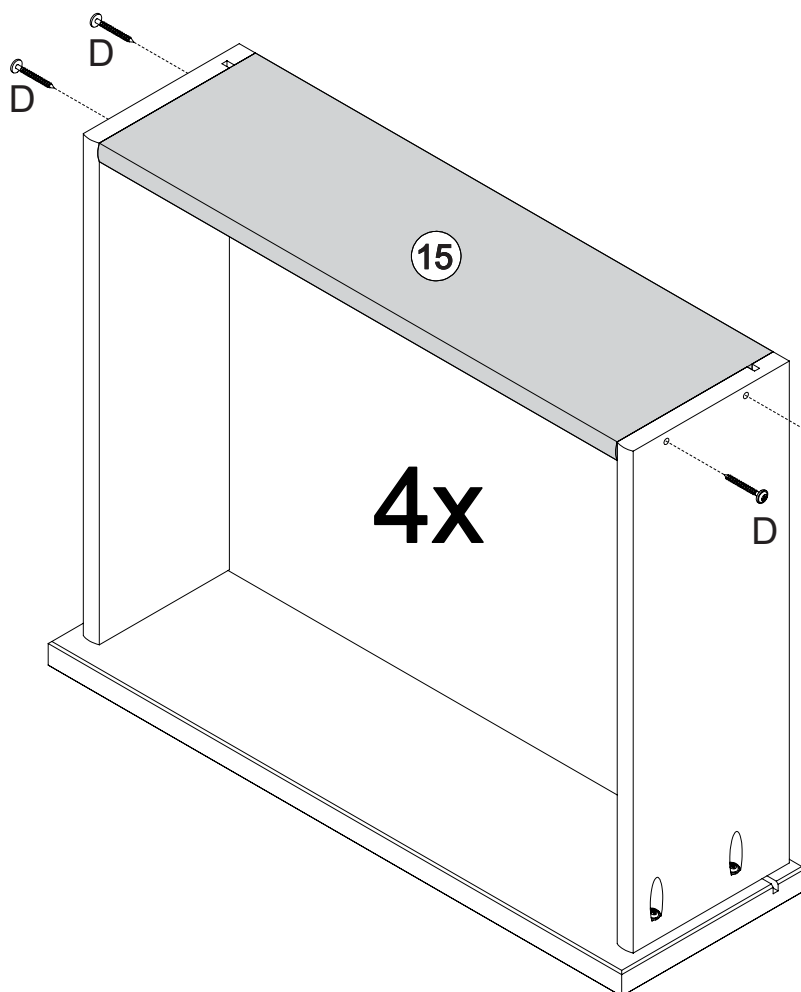

Ø3,5x30mm
16x D

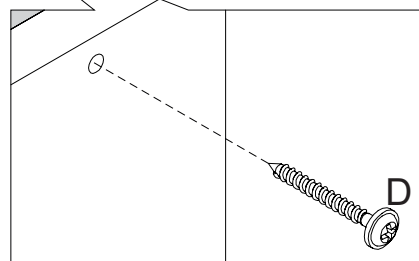
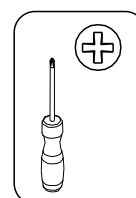

5

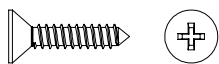

Ø3,5x16mm
24x F

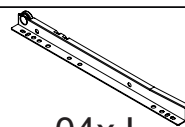

04x L



04x M

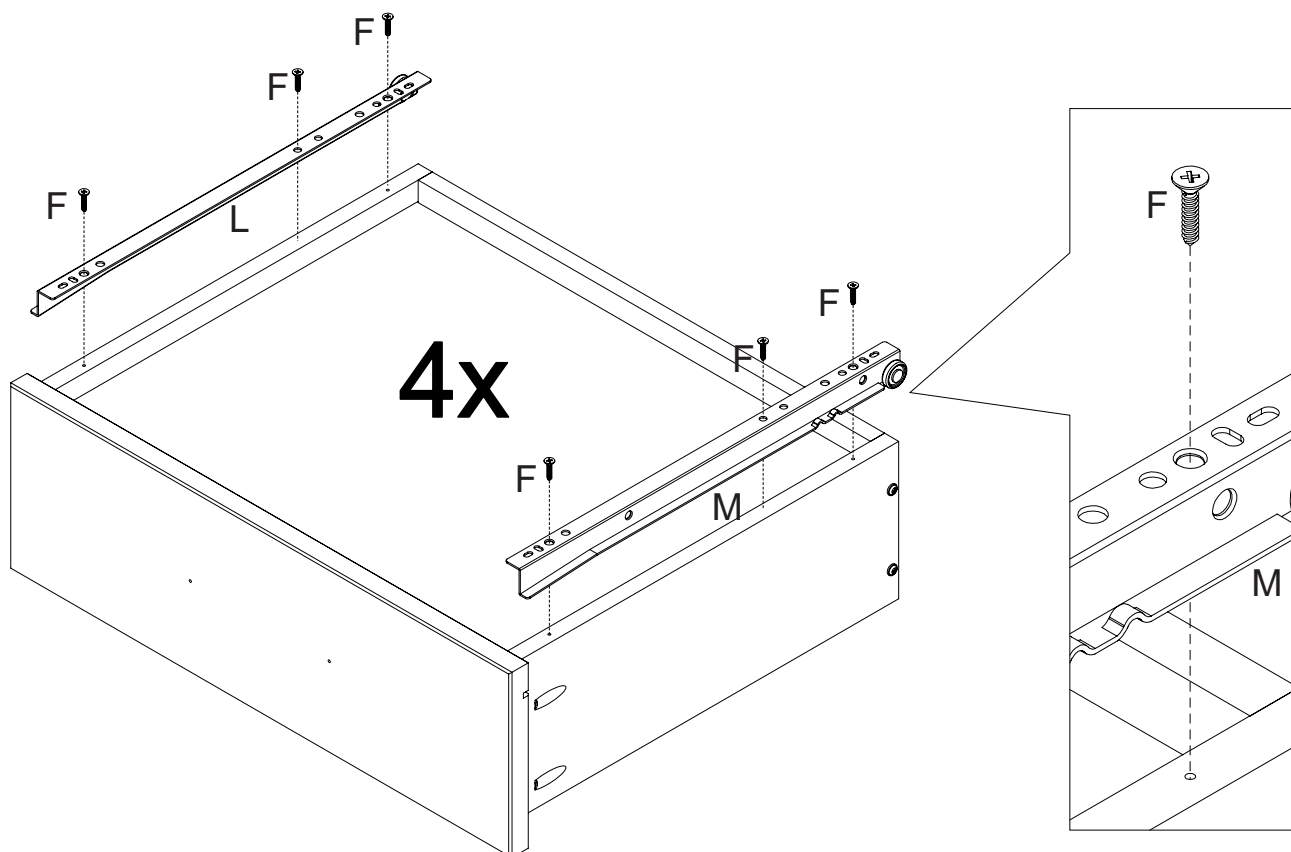

6

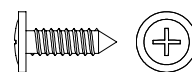

Ø3,5x12mm
08x G

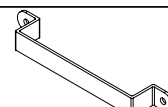

4x Q

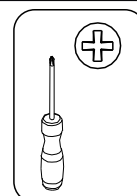
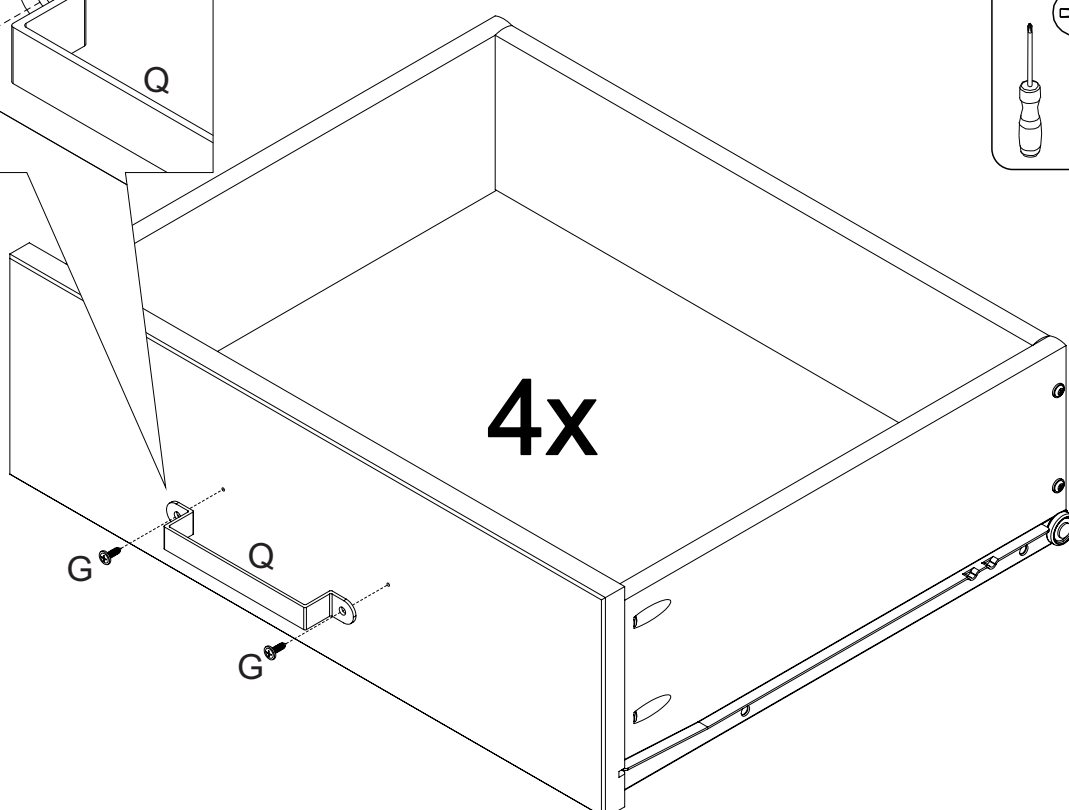
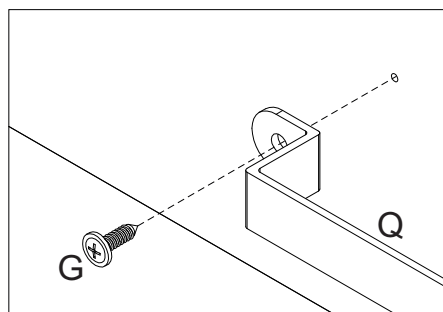

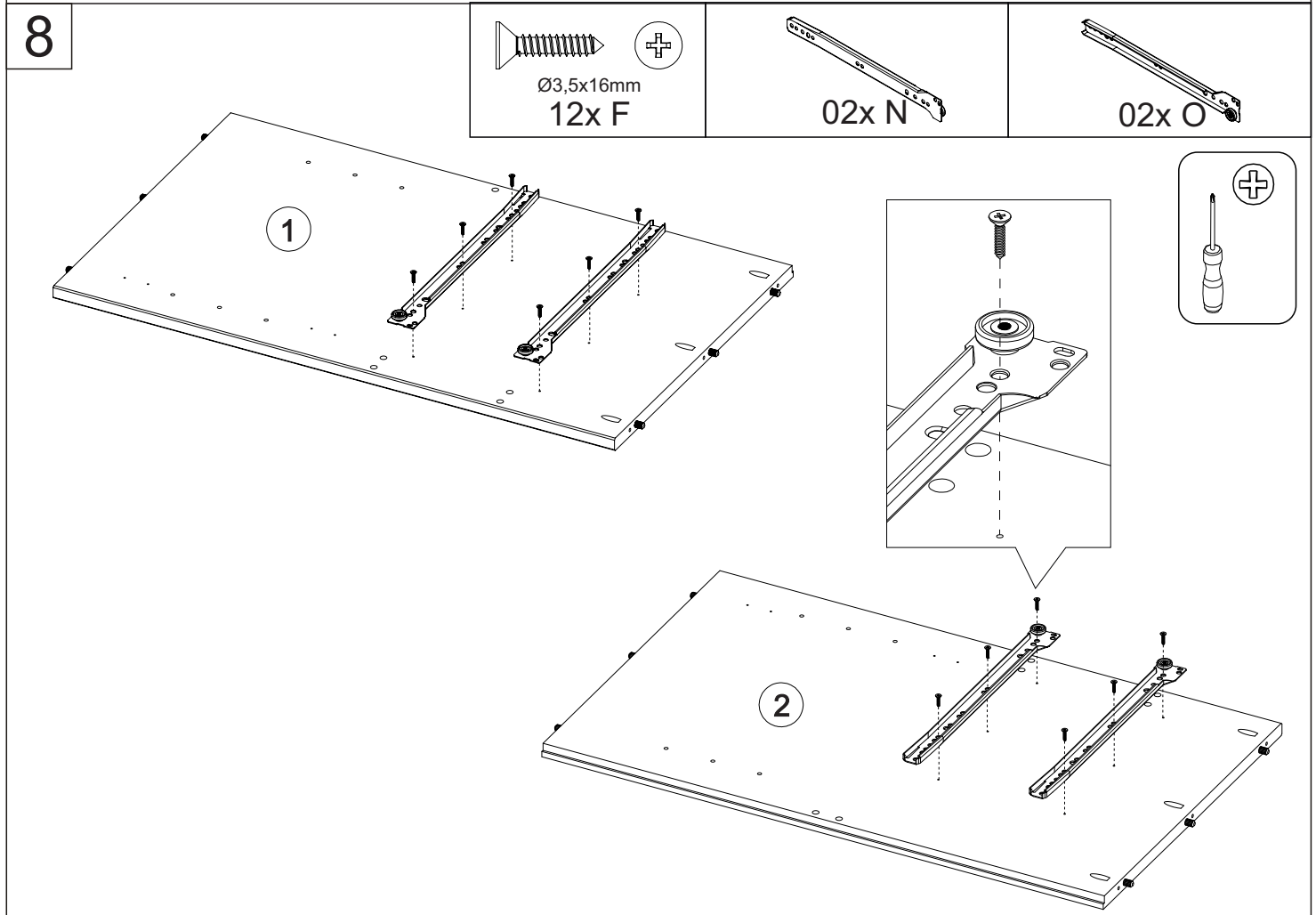
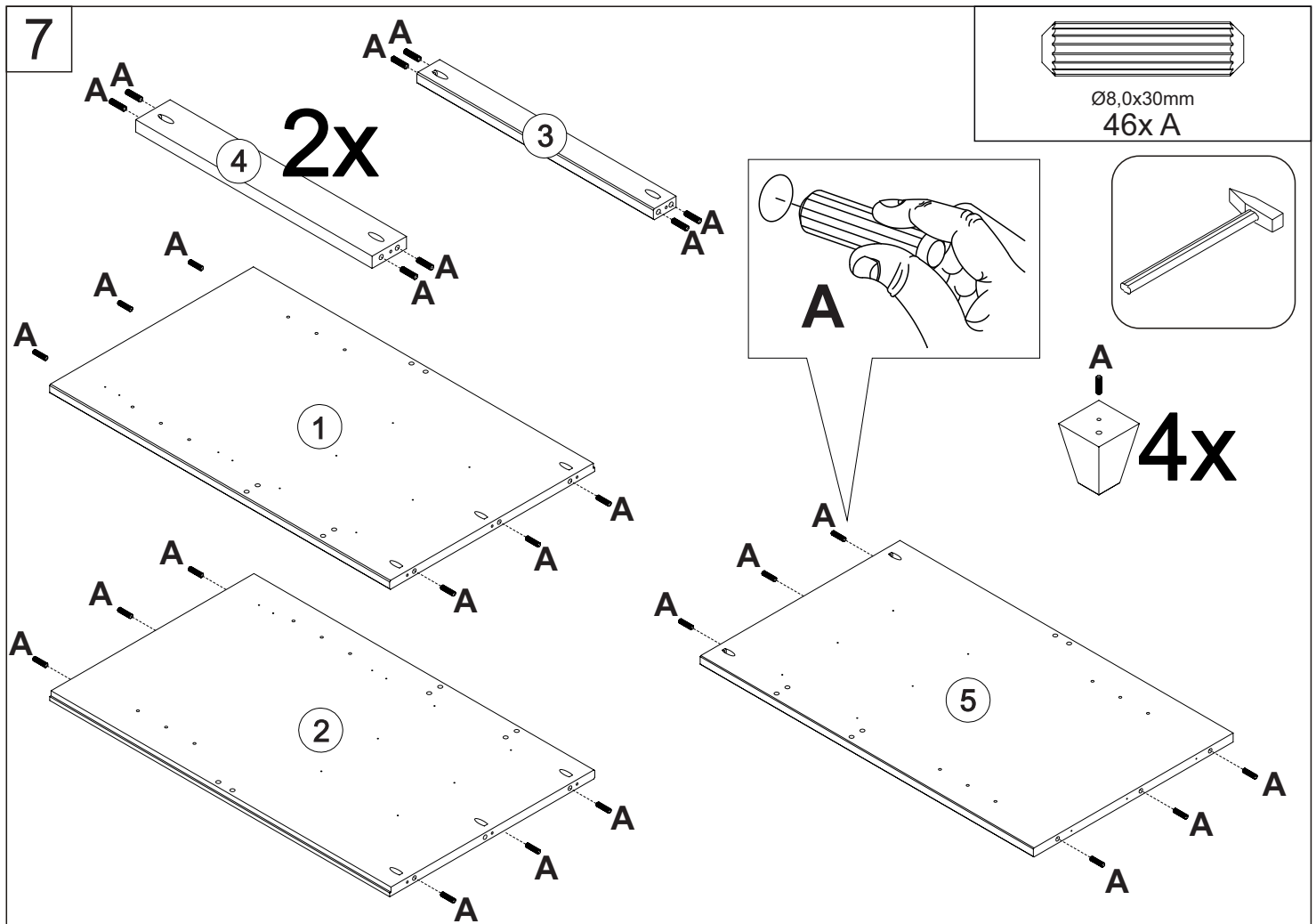

9

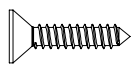

Ø3,5x16mm
12x F



02x N

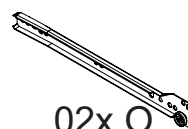

02x O

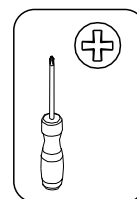
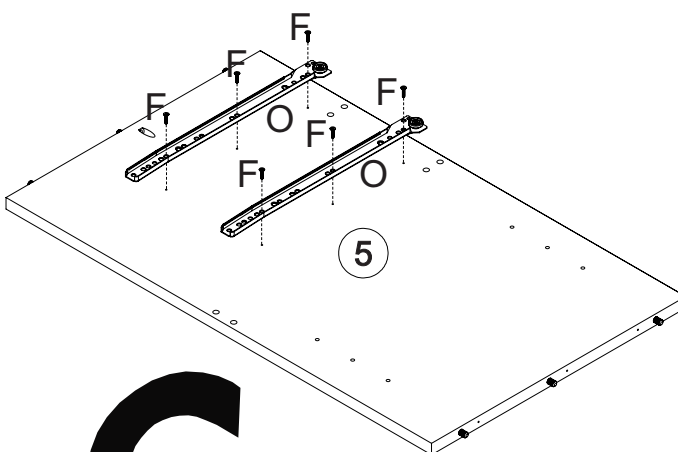
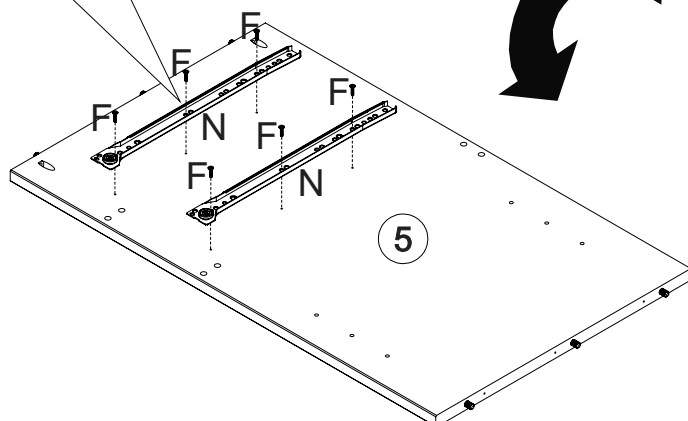
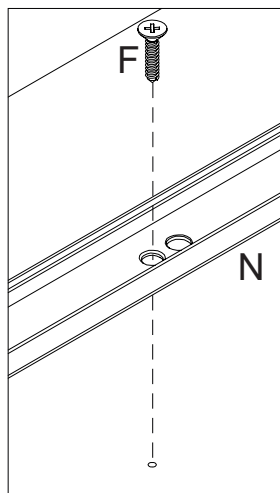

10

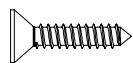

Ø3,5x16mm
08x F

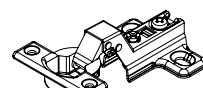

02x P

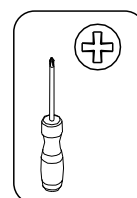
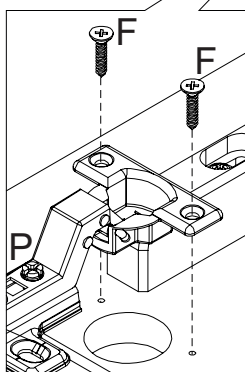
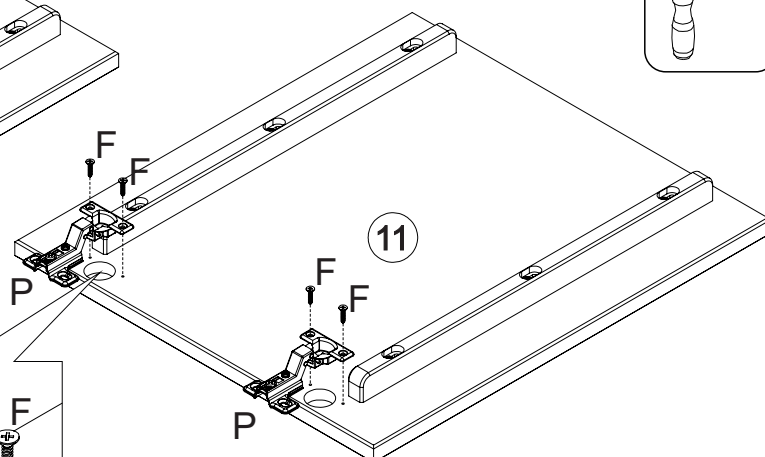
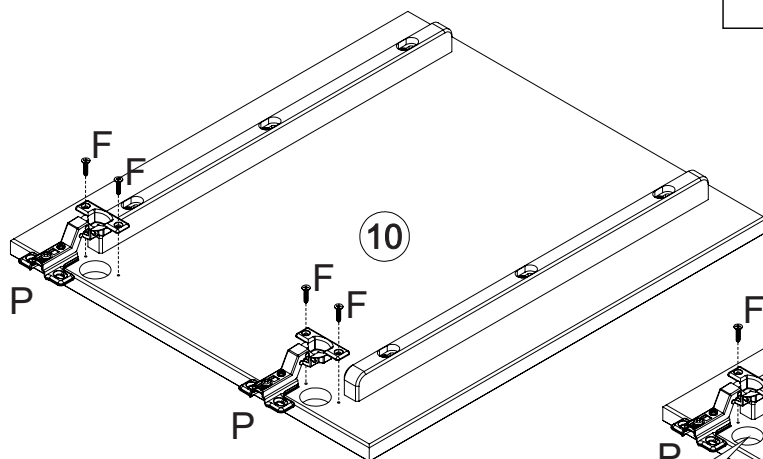

11

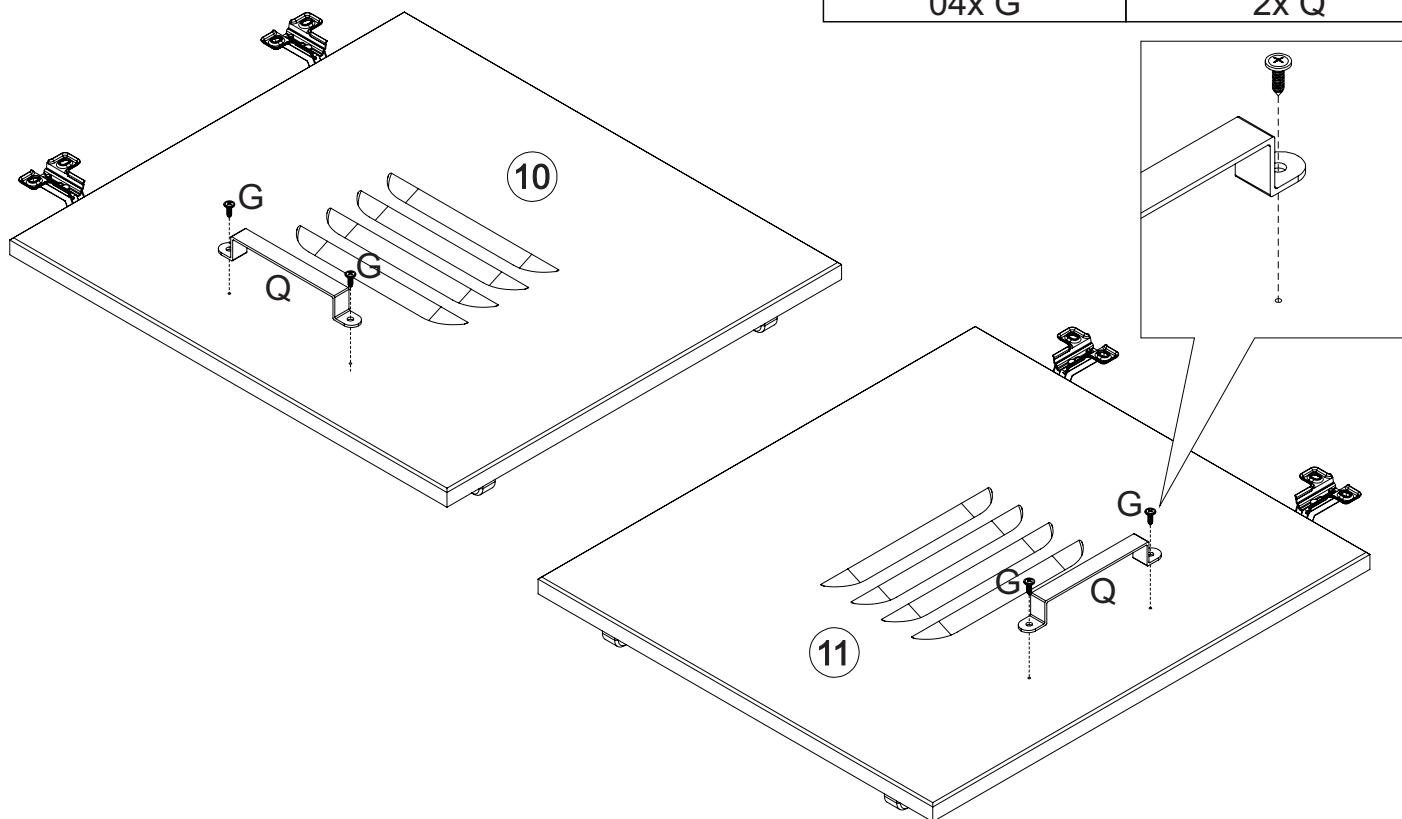
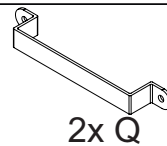
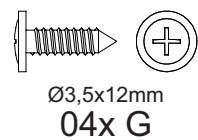

12

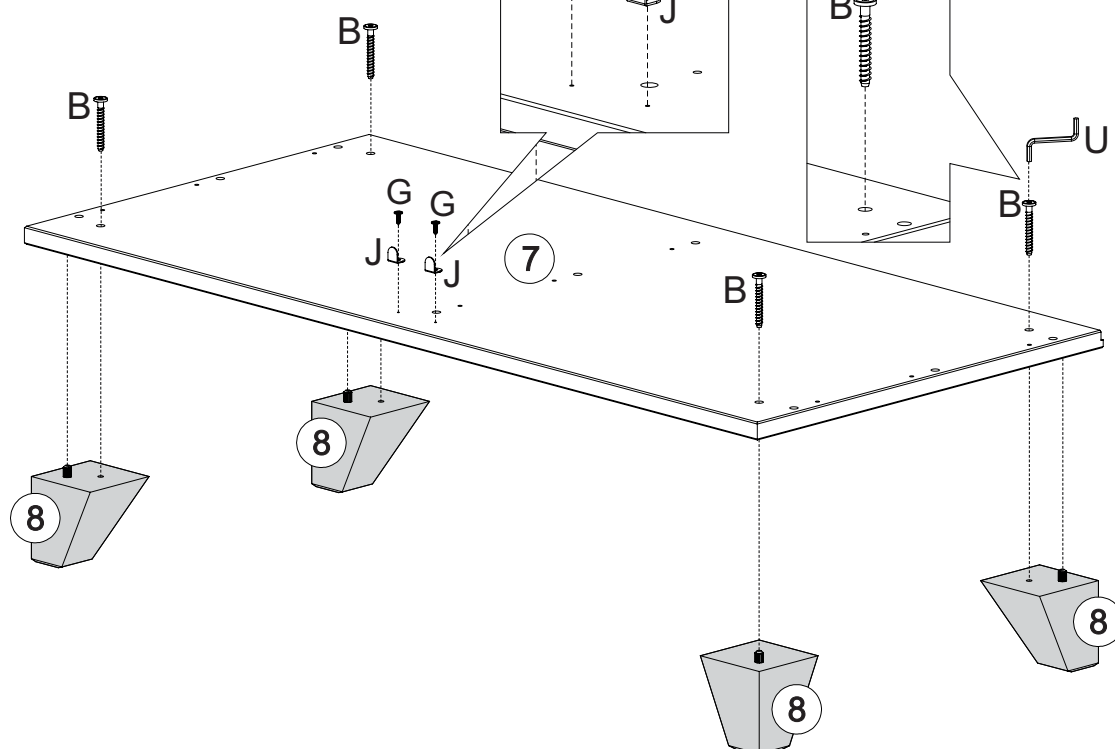
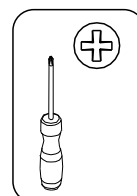
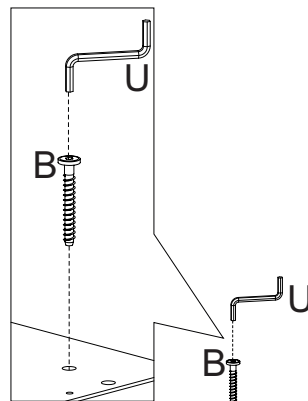
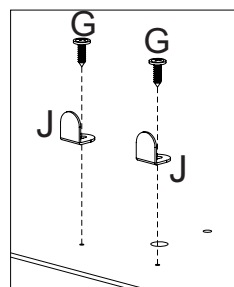
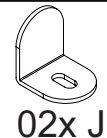
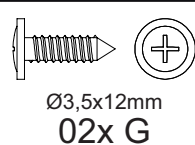
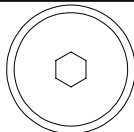
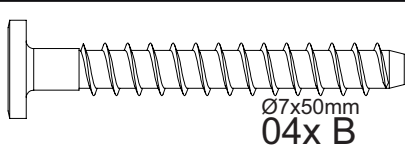

13

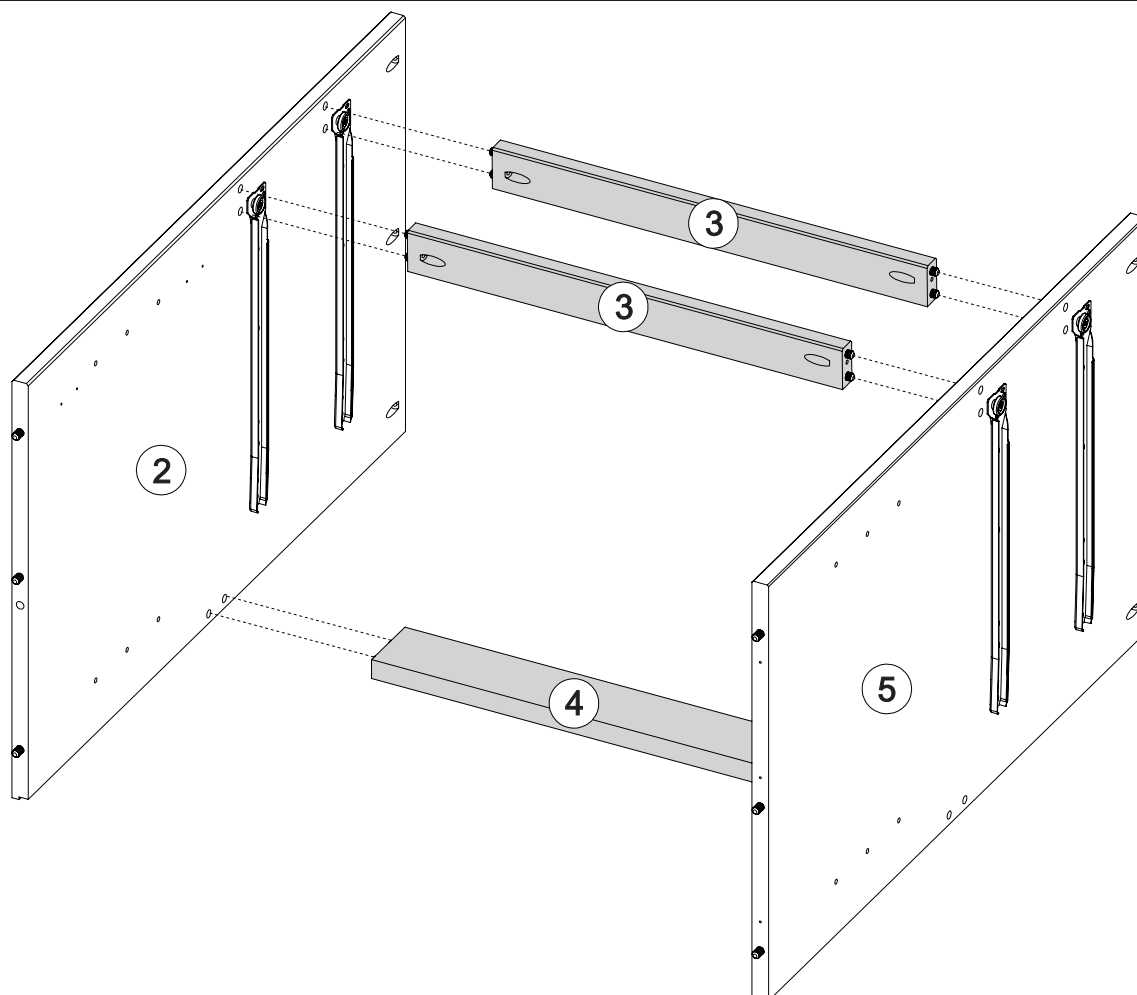

14

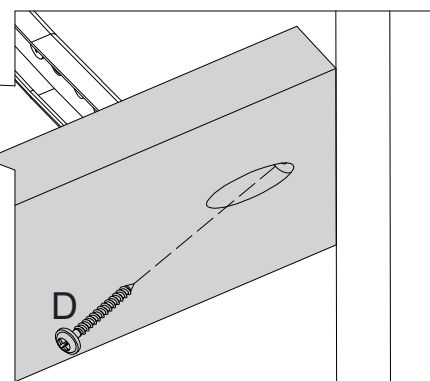
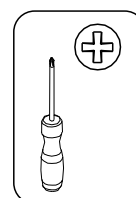
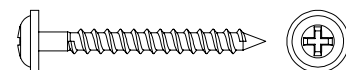
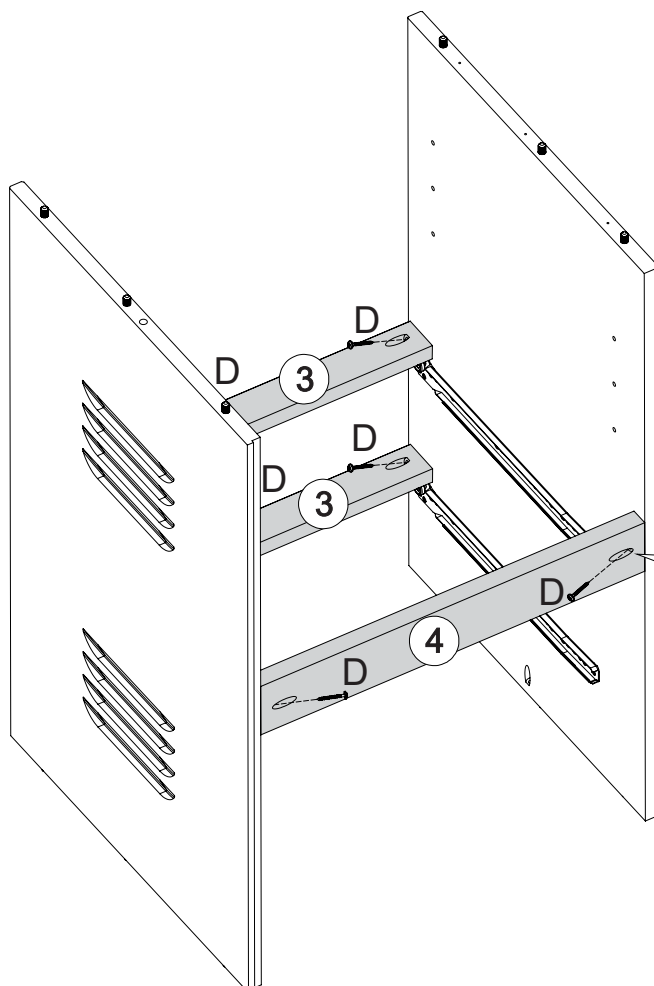

15

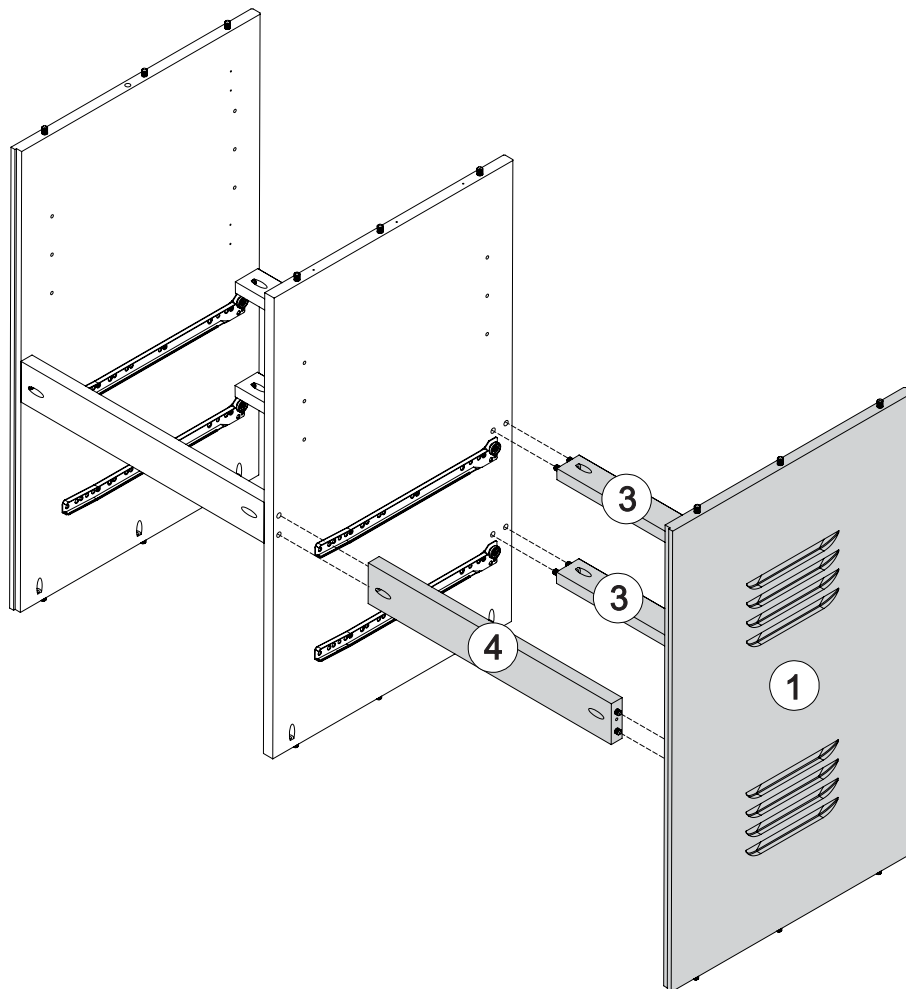

16

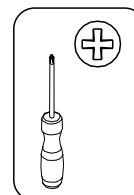
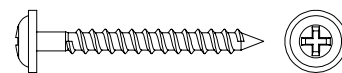
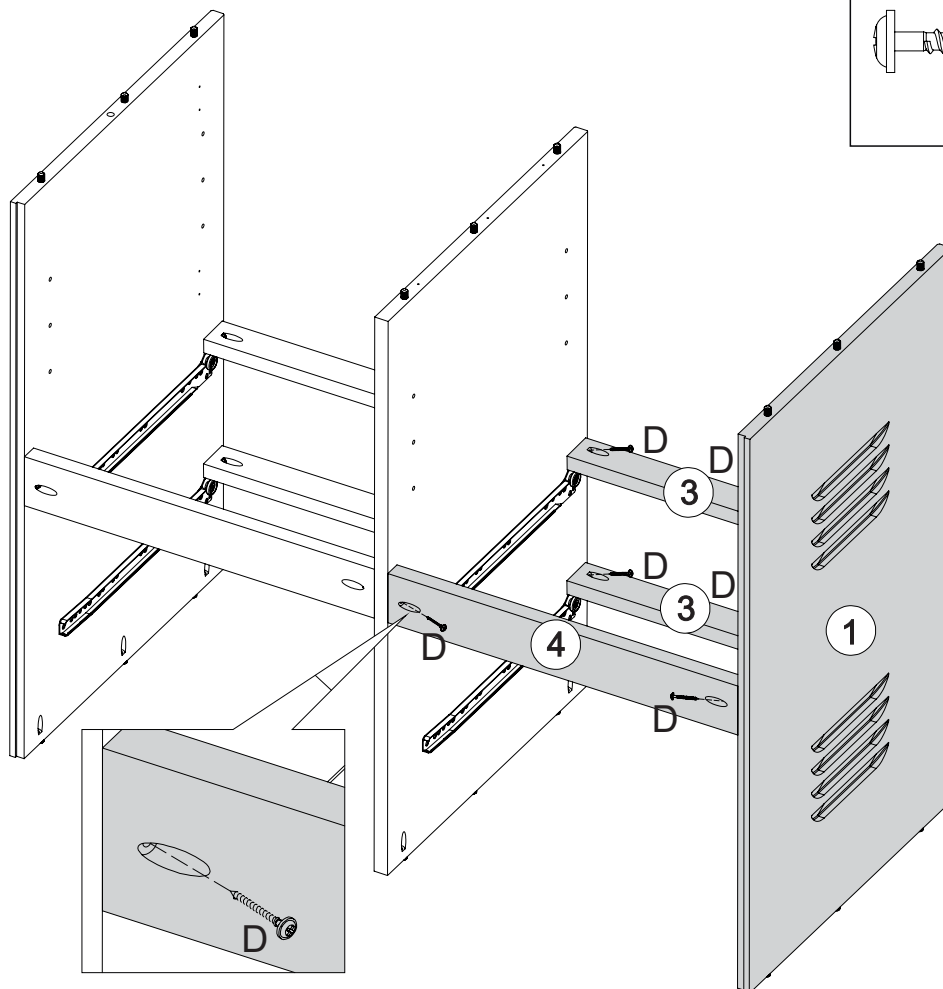

17

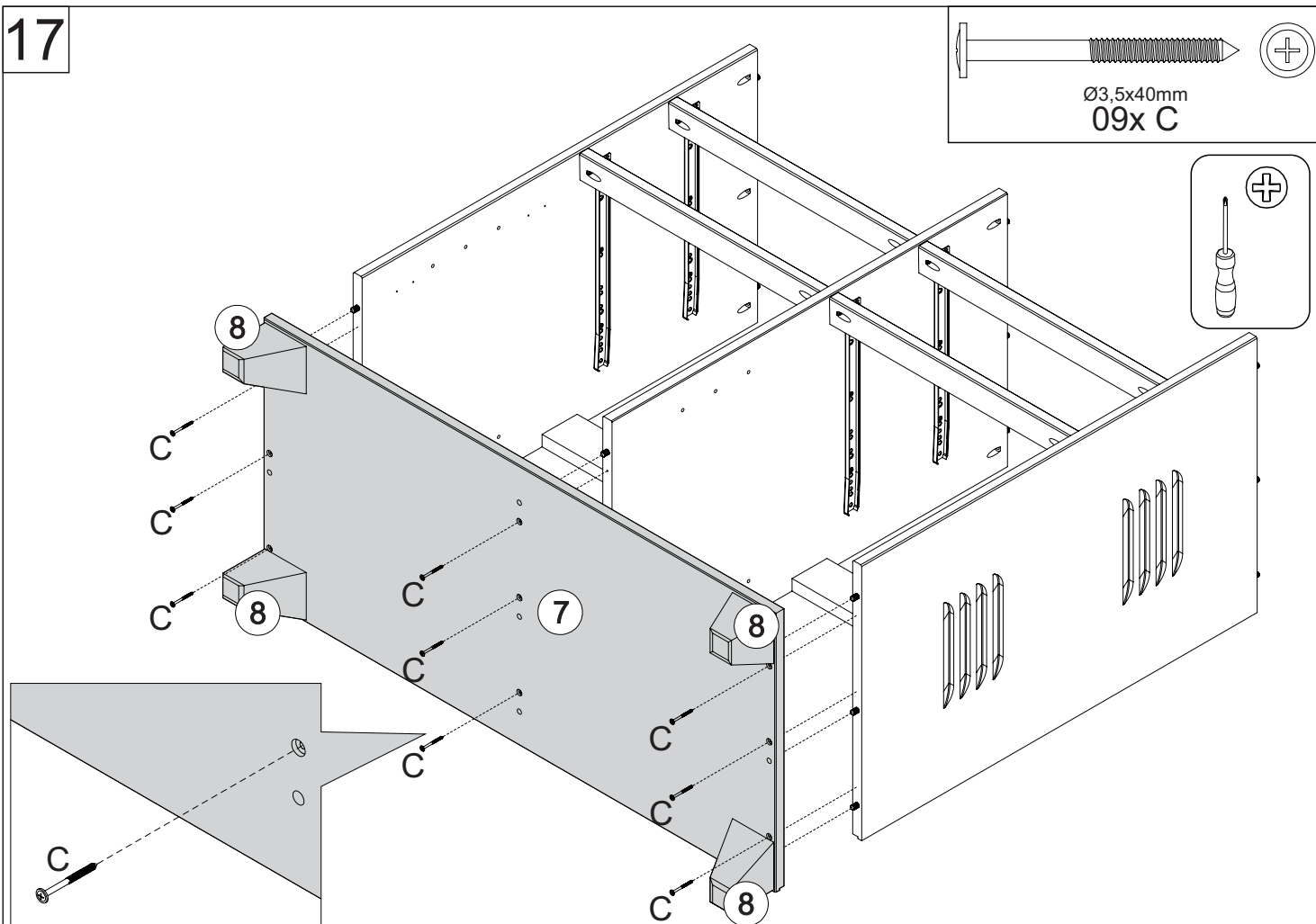

18

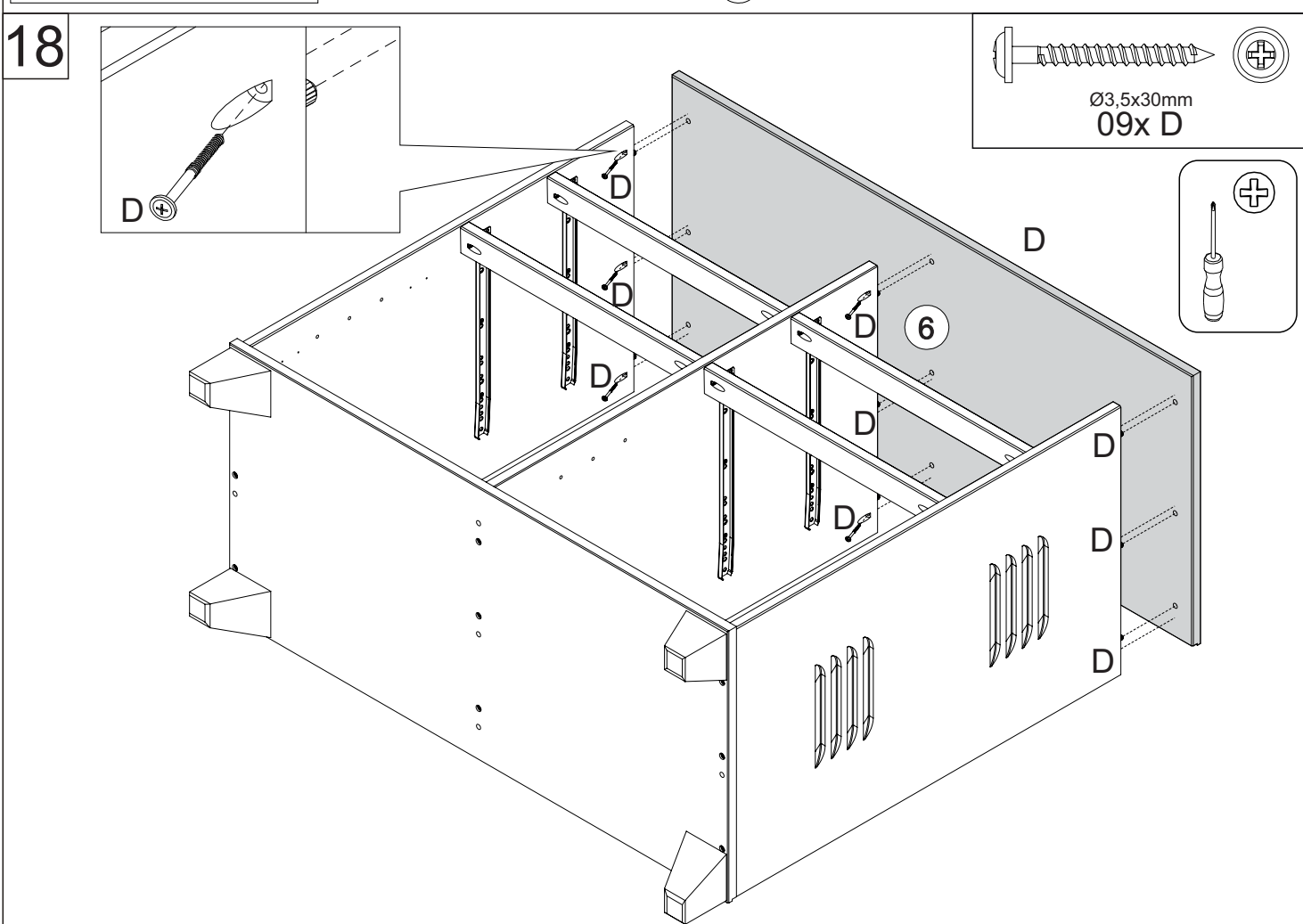

19



28x H

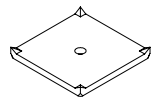

05x K

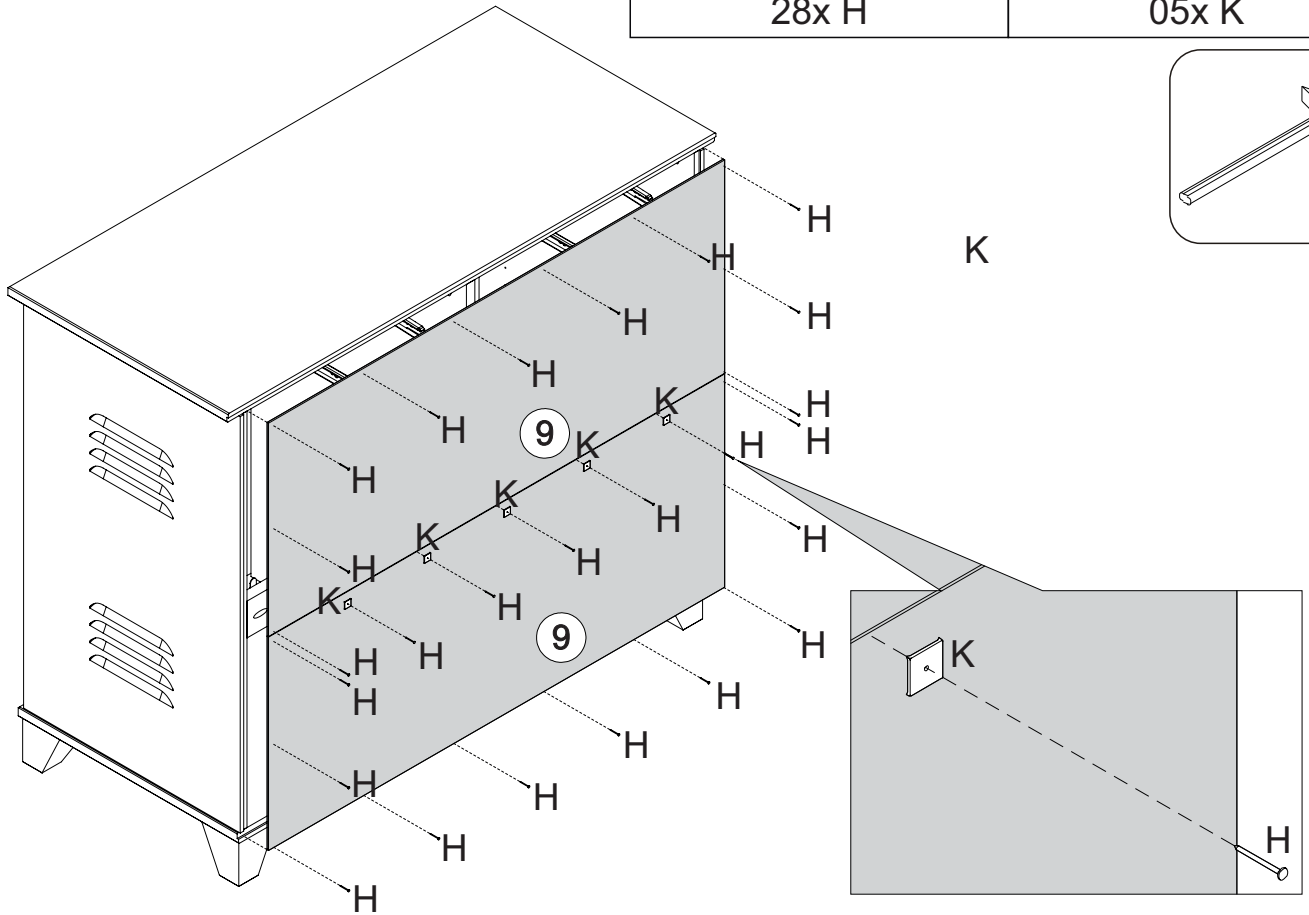
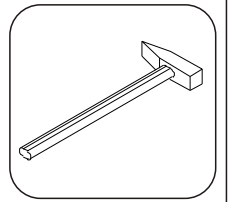

20

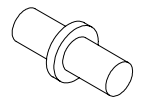
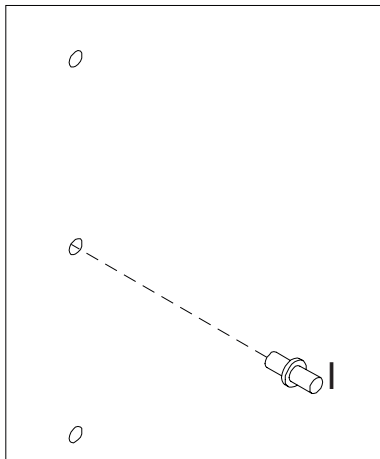

08x I

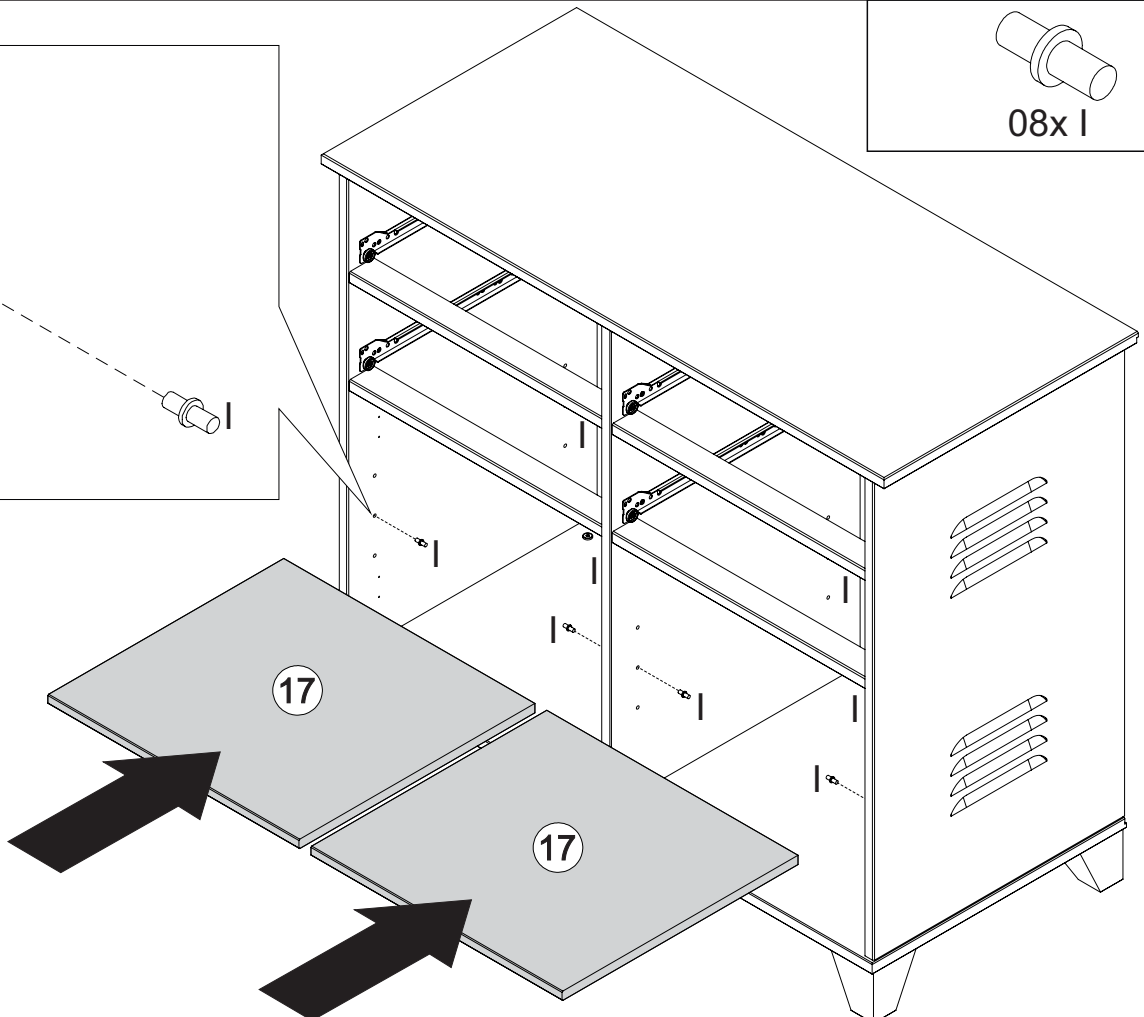

21

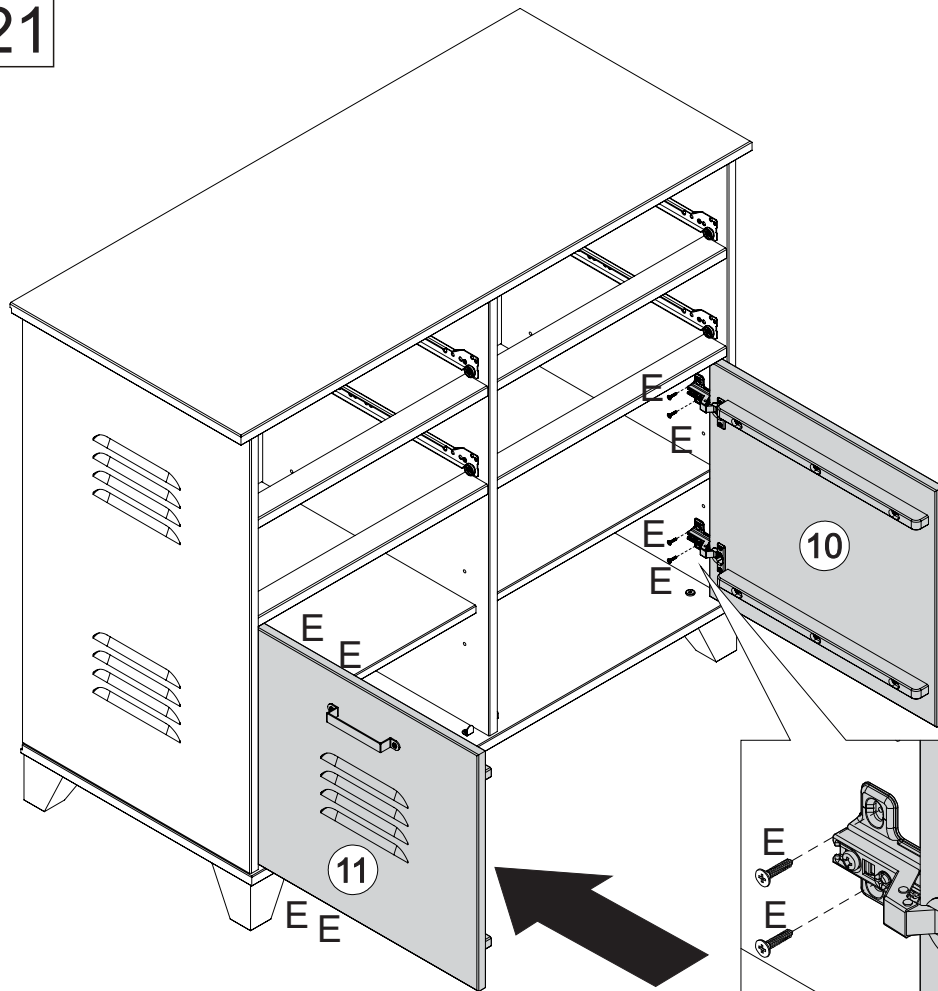

Ø3,5x16mm
08x E

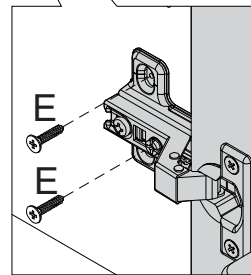
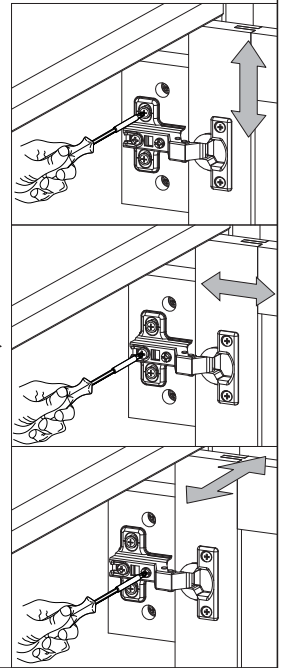
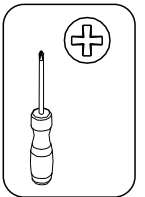

22

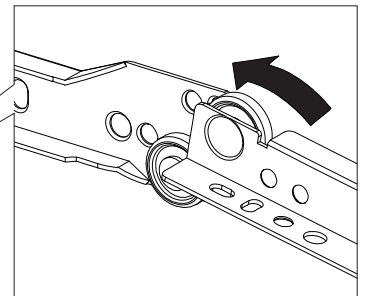
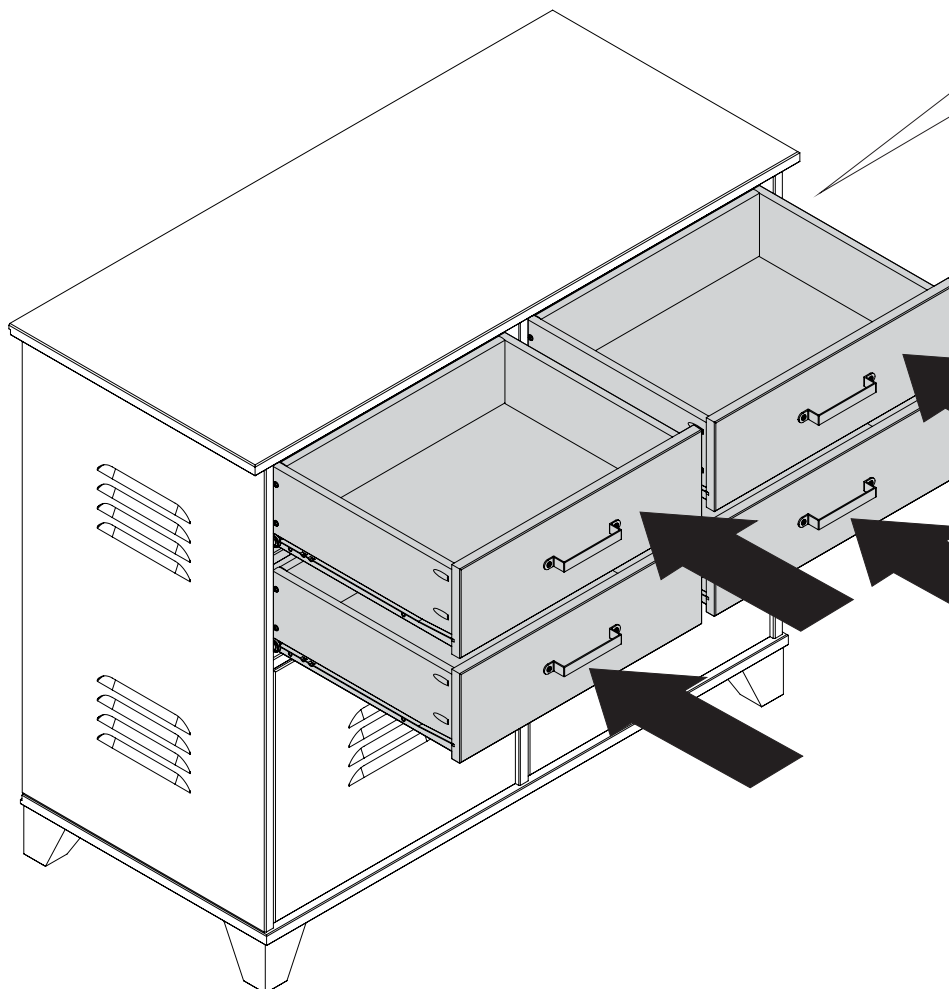

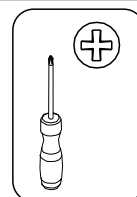
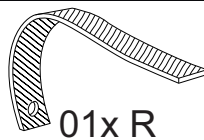
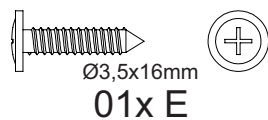

ATTENTION:

Fixation murale OBLIGATOIRE.
Compulsory wall fitting.

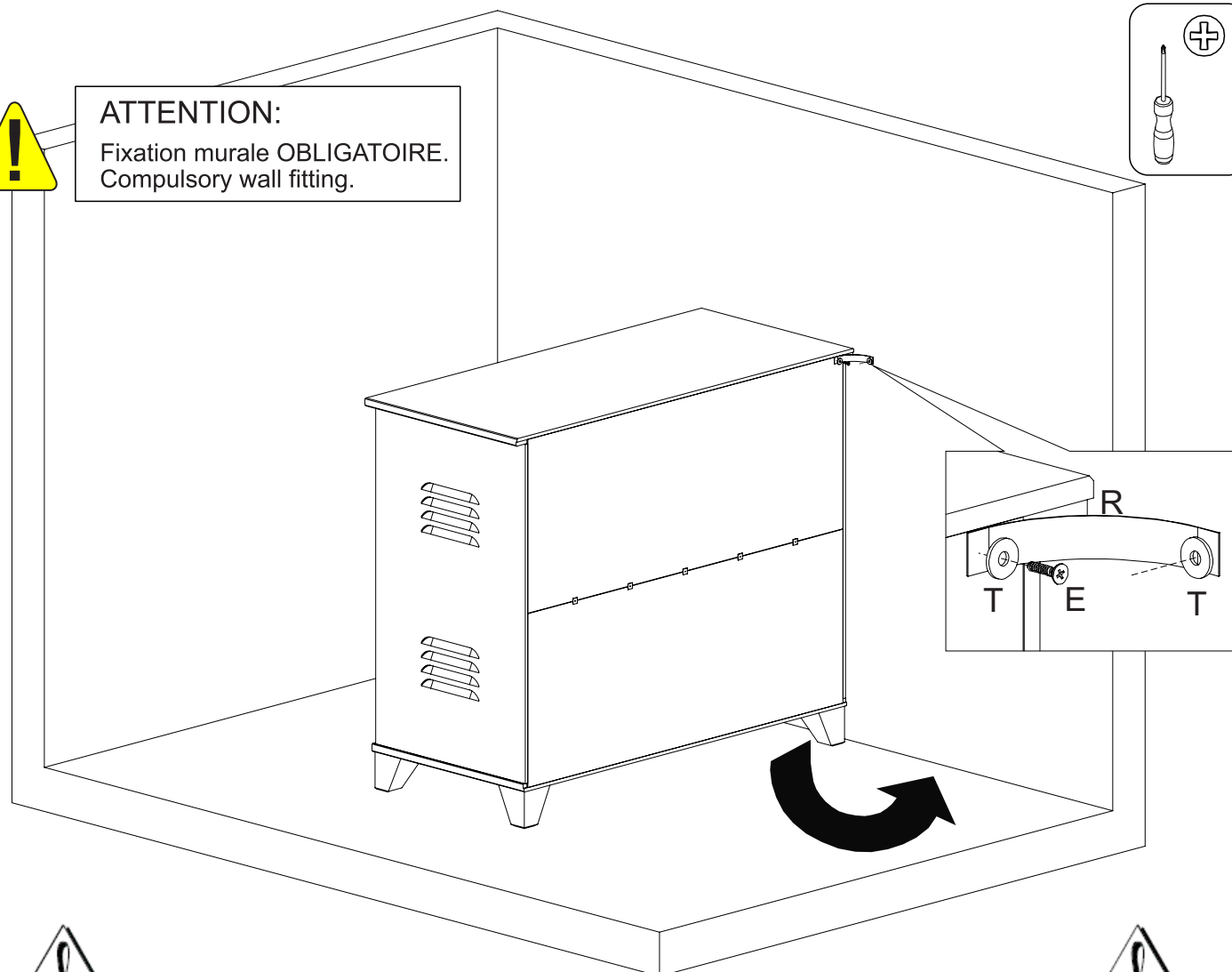

Il existe une grande diversité de types de murs ou cloisons, c'est la raison pour laquelle nous ne pouvons vous fournir le type exact de fixation. Il est nécessaire d'identifier le type de paroi à laquelle vous allez fixer ce produit afin de vous procurer les fixations appropriées. Voici quelques exemples de fixations conseillées pour :



LES MURS PLEINS

CHEVILLE NYLON "FISCHER"

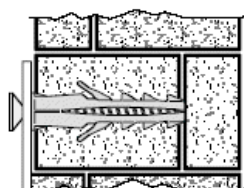
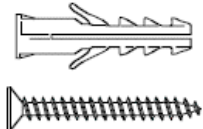

CHEVILLE D'ANCRAGE MÉTAL

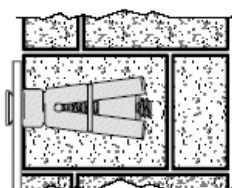
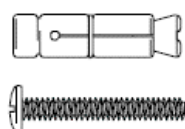

CHEVILLE D'ANCRAGE A AILETTES EN NYLON

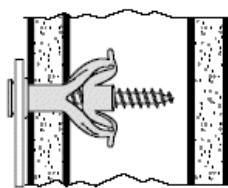
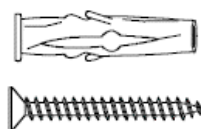

LES CLOISONS CREUSES

CHEVILLE MÉTALLIQUE A EXPENSION

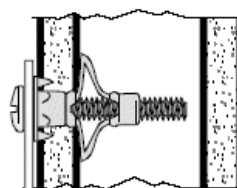
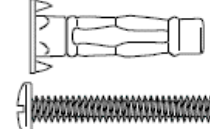

CHEVILLE "MOLLY"

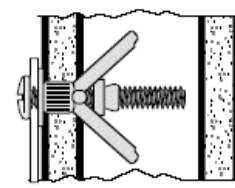
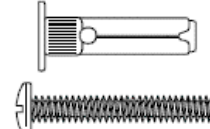

Utiliser une taille de forêt adaptée à la quincaillerie utilisée et au type de mur.

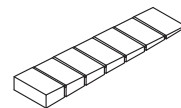

02x S

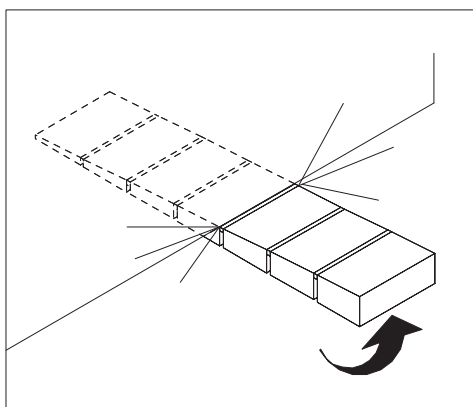
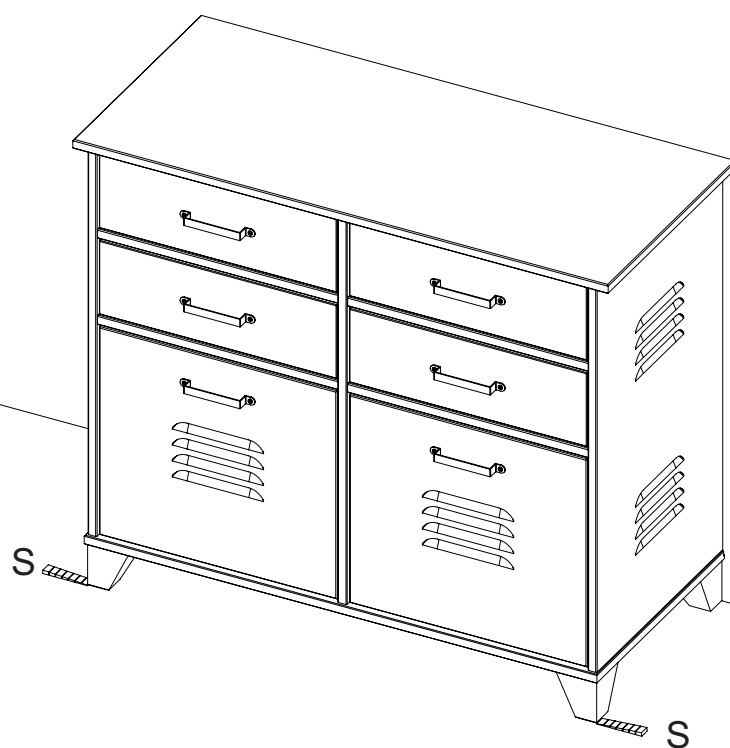

Consignes d'entretien

- chiffon doux légèrement humide

Warning



- avant tout entretien, dépoussiérer soigneusement
- toute tache doit être nettoyée rapidement
- ne jamais utiliser de produit abrasif (poudre, laine d'acier)
- ne jamais utiliser de solvant
- ne pas mouiller

Charge maxi d'utilisation:

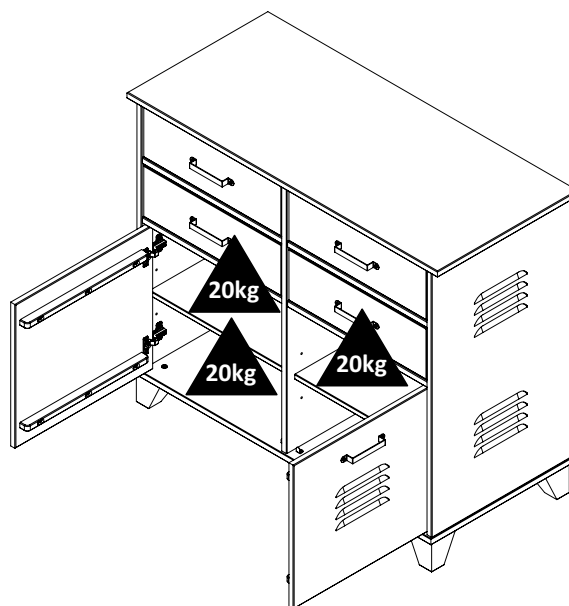
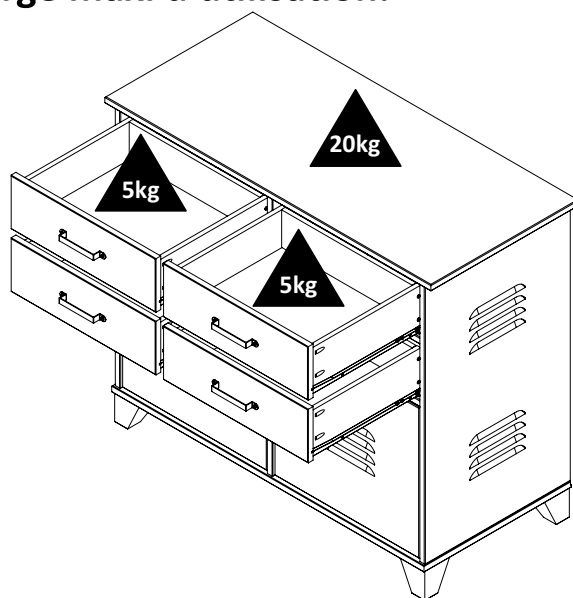

« Lors de l'élimination de votre mobilier usagé, les composants en bois, plastiques et en métal peuvent être séparés et dirigés en déchèterie vers les contenants appropriés pour permettre leur valorisation. Pour plus d'information: www.eco-mobilier.fr »

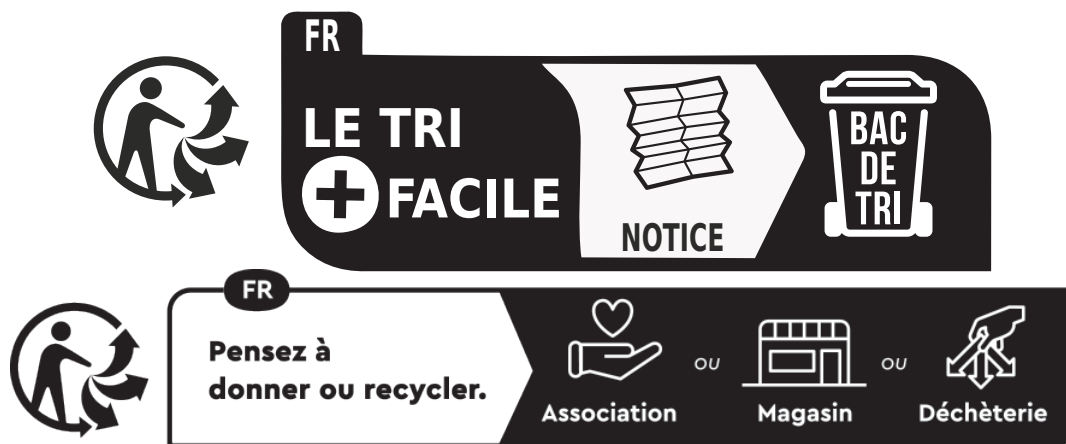

<https://quefairedemesdechets.fr>